

CARE & COMPANY

ESTATE AGENTS • AUCTIONEERS • VALUERS

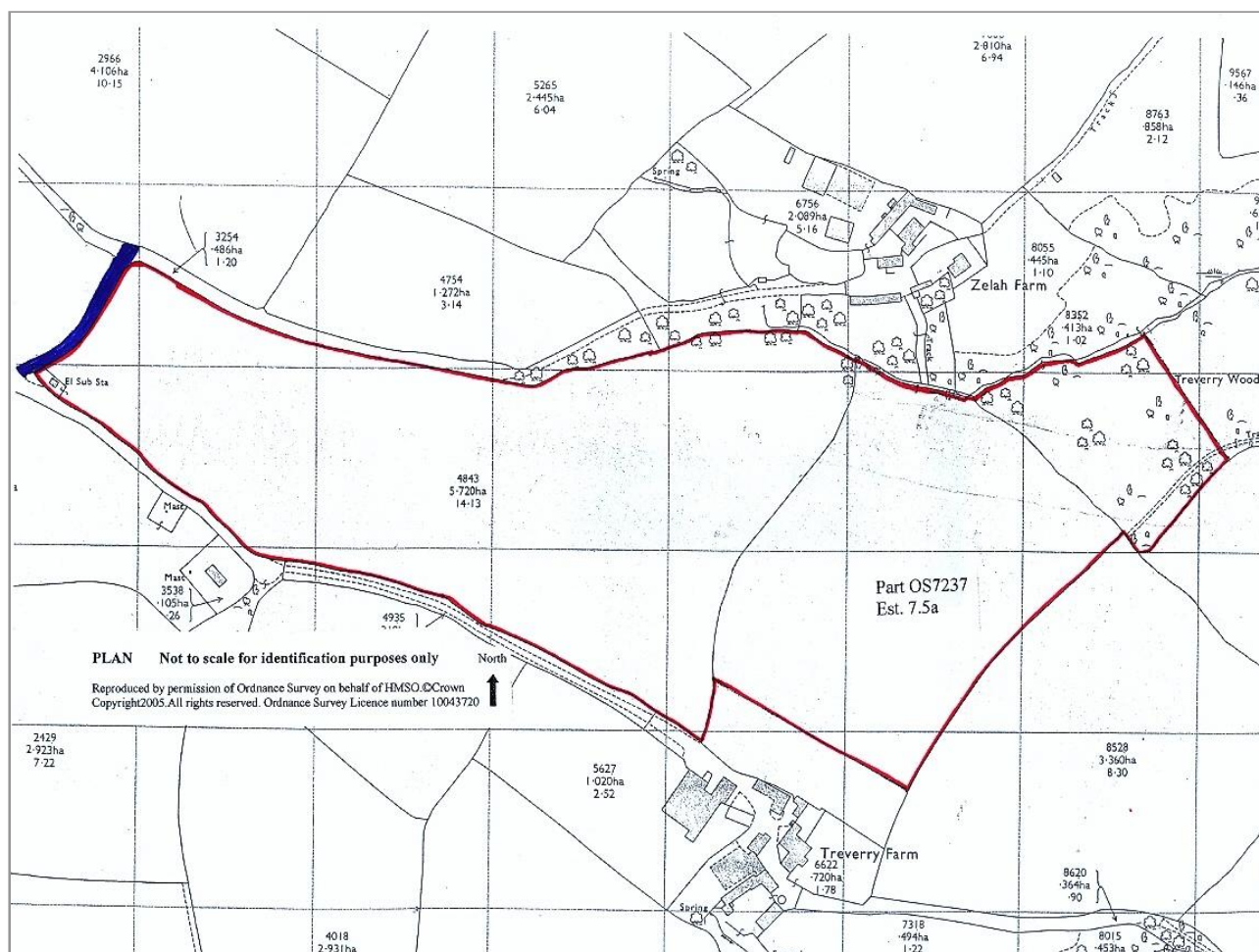
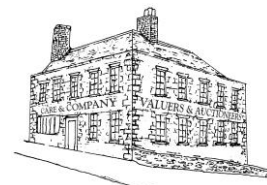

Land at Zelah Farm, Mawgan, Helston TR12 6BD

Land extending to approximately 23.6 acres divided into two main enclosures of productive agricultural land together with approximately 2 acres of mature woodland.

Monument House, 58 Coinagehall Street, Helston, Cornwall TR13 8EW

Tel: 01326 565956

Land at Zelah Farm, Mawgan, Helston TR12 6BD

The land in all extends to approximately 23.6 acres of which approximately 21.6 acres is good quality, productive agricultural land capable of producing a wide variety of rotational crops. Zelah Farm lies approximately three miles to the south east of Helston town midway between the villages of Mawgan and Gweek. The land is currently laid to pasture with good road access and a sub meter for mains water supply.

Tenure – Freehold subject to vacant possession being available as of 31st October 2019 (currently let for summer grazing and mowing).

Access – The land plan shows an area shaded blue which is part of a private lane, over which a right of way will be granted for full and free access at all times, subject to a share of future maintenance.

Water – There is a mains water supply to the land via a sub meter from the main farm supply. The purchaser of the land will be charged per cubic meter at South West Water charges for the period and will be responsible for one third of any future maintenance of any pipework etc.

Price – Offers in excess of £160,000

VIEWING: Strictly by appointment with the vendors agents.

CARE & COMPANY

58 Coinagehall St, Helston. TR13 8EW

01326 565956

careandcompany@btconnect.com

www.careandco.co.uk

INSTRUCTION: 15 June 2018 PHOTOGRAPHS: 15 June 2018

AGENTS NOTES These particulars have been produced for general guidance only and the descriptions, measurements and photographs do not form part of any contract. All maps or extracts have been reproduced under Ordnance Survey Licence No. 100043720 and are not to scale or give any guarantee of boundaries or surroundings. No survey has been carried out on any part of the property or any testing of services, appliances or specific fittings or equipment, by the selling agents.

